



*i-VMD Type2 : Intruder Detection / Loitering Detection / Direction Detection / Scene Change Detection / Object Detection / Cross Line Detection

HD / 1,280 x 720 60 fps H.264 Vandal Resistant Network Camera featuring Super Dynamic

Key Features

- **720p** HD images up to **60 fps**^{*1}
- Approximate 1/3 inches, high sensitivity MOS image sensor
- Maximum Screen Size is 1,980 x 1,080* @30 fps, H.264
* Used by super resolution technology
- **Multiple H.264 (High profile) streams (max. 4 streams)** and **JPEG** streams ensure simultaneous real time monitoring and high resolution recording.
- **Enhanced Super Dynamic**^{*1} and **ABS (Adaptive Black Stretch)** technologies deliver **133 dB** wider dynamic range compared to conventional cameras.
- **Smart coding Technology** : Group of Pictures (GOP) control function removes unnecessary information from the frame for realizing efficient encoding. With the latest bit rate reducing technology, GOP control, 3D-MNR (Multi process Noise Reduction) and FDF(Frequency Divided Filter), the network bandwidth and the disk space of recorder can be saved.
- High sensitivity with Day/Night (ICR*: WV-SFV311A, Electrical: WV-SFV310A) function:
WV-SFV311A : 0.01 lx (Color), 0.003 lx (B/W) at F1.6
WV-SFV310A : 0.01 lx (Color), 0.008 lx (B/W) at F1.6
*ICR: IR Cut filter Removal
- New camera attachment bracket allows an **easy camera installation** toward all four directions.
- **ABF (Auto Back Focus)** ensures easy installation.
- **VIQS (Variable Image Quality on Specified area)** technology allows the designated **eight areas** to retain higher image quality while the excluded area will have a decreased image quality, which enables to use lower image file size and bit rate.
- Cropping function enables to provide whole image and the part image simultaneously. Up to 4 image capture areas can be specified, and it is also possible to control the sequence.
- **Face Super Dynamic** technology ensures clear face image.
- Lens distortion compensation for the distorted images can be adjusted 256 steps.
- Selectable light control modes:
Outdoor scene, Indoor scene (50 Hz) / Indoor scene (60 Hz), Fix shutter
Indoor scene (50 Hz/60Hz):
Flicker caused by fluorescent lightning will be automatically compensated.
- 2x extra optical zoom at 640 x 360 resolution
- 2x, 4x digital zoom controlled by browser
- VMD (Video Motion Detection) with 4 programmable detection areas, 15 steps sensitivity level and 10 steps detection size
- Privacy Zone can mask up to 8 private areas, such as house windows and entrances/exits.
- Camera title display: Up to 20 alphanumeric characters on the browser
- Alarm sources including 3 terminal input, VMD and Panasonic alarm command can trigger actions such as SDXC/SDHC/SD memory recording, FTP image transfer, E-mail notification, Indication on browser, Alarm terminal output, and Panasonic alarm protocol output.
- Full duplex bi-directional audio allows interactive communication between camera site and monitoring site. (WV-SFV311A only)
- JPEG Image compression ratio can be changed by alarm so that higher quality image can be provided.
- Prioritized stream control: One of the video streams can be prioritized when multiple recorders or client PCs are accessing the camera so that the recorder or the client PC can maintain the frame rate.
- Newly developed dome cover provides clearer images above the horizontal. Thereby, it expands the tilting range of the lens.
- Face detection function detects the position of human face and the information is sent by XML or video stream. (Optional)
- Can be added new intelligent extension software (Optional) in addition to built-in VMD (Video Motion Detection), alarm function.
- **Fog compensation function** equipped as standard.
- **HLC (High Light Compensation)** technology reduces strong light sources such as vehicle headlights to prevent camera being blinded.
- **SCC (Super Chroma Compensation)** function realizes a better color reproducibility even in low illumination.
- H.264 max. bit rate/client and Total bit rate control allows flexible network traffic management. Frame rate priority mode controls bit rate and compression ratio to provide the specified frame rate.
- Internet mode: H.264 images can be transmitted over HTTP protocol.
- Multi-language : English / Italian / French / German / Spanish / Portuguese / Russian / Chinese / Japanese
- IPv4/IPv6 protocol supported
- Supports SSL, DDNS (viewnetcam, RFC2136)
- Still images (JPEG) can be viewed on mobile phones via Internet.
- ONVIF compliant model
- IP66 rated water and dust resistant. Compatible with IEC60529 measurement standard, Type 4X(UL50), NEMA 4X compliant.
- Dehumidification device for use with various weather conditions
- Vandal resistant mechanism for high reliability

*1 Super Dynamic function is automatically set off on 60 fps mode.

Optional Accessories

Ceiling Mount Bracket WV-Q169A 	Smoke Dome Cover WV-CW7S 	Sun Shade WV-Q7118 
Ceiling Mount Bracket WV-Q121B (Use with the WV-Q124 (suspension mount bracket) to be able to install on a ceiling.)	Wall Mount Bracket WV-Q122A (Use with the WV-Q124 (suspension mount bracket) to be able to install on a wall.)	Mount Bracket WV-Q124 (Use when installing the WV-SFV311A / WV-SFV310A using the WV-Q122A.)

Specifications

Camera	Image Sensor	Approx. 1/3 type MOS image sensor	
	Scanning Mode	Progressive scan	
	Scanning Area	4.86 mm (H) x 3.89 mm (V) (3/16 inches(H) x 5/32 inches(V))	
	Minimum Illumination	WV-SFV311A Color: 0.01 lx, BW: 0.003 lx (F1.6, Maximum shutter: Max. 1/30s, Gain: On(High)) Color: 0.0007 lx, BW: 0.0002 lx (F1.6, Maximum shutter: Max. 16/30s, Gain: On(High)) ¹ WV-SFV310A Color: 0.01 lx, BW: 0.008 lx (F1.6, Maximum shutter: Max. Off (1/30s), Gain: On(High)) Color: 0.0007 lx, BW: 0.0005 lx (F1.6, Maximum shutter: Max. 16/30s, Gain: On(High)) ¹	
	White Balance	AWC (2,000 - 10,000 K), ATW1 (2,700 - 6,000 K), ATW2 (2,000 - 6,000 K)	
	Light Control Mode	Outdoor scene/ Indoor scene (50 Hz)/ Indoor scene (60 Hz)/ Fix shutter	
	Shutter Speed	[1.3 mega pixel [16 : 9] (60 fps mode)] Off (1/60), 1/100, 1/120, 1/250, 1/500, 1/1000, 1/2000, 1/4000, 1/10000 Other than [1.3 mega pixel [16 : 9] (60 fps mode)] Off (1/30), 3/100, 3/120, 2/100, 2/120, 1/100, 1/120, 1/250, 1/500, 1/1000, 1/2000, 1/4000, 1/10000	
	Super Dynamic ²	On(High) / On(Normal) / Off	
	Face Super Dynamic	On / Off (Only when Super Dynamic : On)	
	Adaptive Black Stretch	On / Off (Only when Super Dynamic : Off)	
	Fog compensation	On / Off (Only when Super Dynamic/ Adaptive black stretch: Off)	
	AGC	On (Low, Mid, High) / Off	
	Maximum shutter	max. 1/1000 s, max. 1/500 s, max. 1/250 s, max. 1/120 s, max. 1/100 s, max. 2/120 s, max. 2/100 s, max. 1/30 s, max. 2/30 s, max. 4/30 s, max. 6/30 s, max. 10/30 s, max. 16/30 s	
	Day/Night	WV-SFV311A : ICR Mode : Off / On / Auto1 (Normal) / Auto2 (IR Light) / Auto3 (SCC) WV-SFV310A : Electrical Mode : Off / AUTO	
	Dynamic Range	133 dB typ. (Super Dynamic : On, Light Control Mode : indoor)	
	Digital Noise Reduction	High / Low	
	Video Motion Detection	4 areas, Sensitivity : 15 steps, Detection size : 10 steps	
	Privacy Zone / VIOS	On/ Off (up to 8 zones available)	
	Camera Title (OSD)	On / Off, Up to 20 characters (alphanumeric characters, marks)	
	Electric Zoom	TELE / WIDE, Auto Coarse adjustment of Focus	
Focus Adjustment	ABF / MANUAL(Html only)		
Lens Distortion Compensation	256 steps		
Lens	Vari Focal Length	2.8 - 10 mm (1/8 inches - 25/64 inches)	
	Angular Field of View	[16 : 9 mode] Horizontal : 28° (TELE) - 99° (WIDE) Vertical : 16° (TELE) - 54° (WIDE) [4 : 3 mode] Horizontal : 28° (TELE) - 99° (WIDE) Vertical : 21° (TELE) - 72° (WIDE)	
	Maximum Aperture Ratio	1 : 1.6 (WIDE) - 1 : 3.4 (TELE)	
	Focusing Range	0.3 m - ∞	
Adjusting Angle	Horizontal	±180°	
	Vertical	±85°	
Browser GUI	Cropping	H.264(1) / H.264(2) / H.264(3) / H.264(4) / H.264(all) / JPEG(1) / JPEG(2) / JPEG(3) Up to 4 image capture areas can be specified	
	Camera Control	Brightness, AUX On / Off	
	Display Mode	Spot, Quad : Image from 16 cameras can be displayed in 4 different Quad screens or 16 split screen (JPEG only), 20 characters camera title available.	
	Digital Zoom / Camera Title	1x, 2x, 4x controlled by browser GUI / Up to 20 alphanumeric characters	
	Clock Display	Time : 12H/24H, Date : 5 formats on the browser, Summer time (Manual)	
	Alarm Control	Reset	
	One Shot Capture	A still picture will be displayed on a newly opened window.	
	Audio (WV-SFV311A only)	Mic (Line) Input : On / Off Volume adjustment : Low / Middle / High Audio Output : On / Off Volume adjustment : Low / Middle / High	
	SD Memory Data Download	Still or motion images recorded in the SDXC/SDHC/SD memory card can be downloaded.	
	GUI / Setup Menu Language	English, Italian, French, German, Spanish, Portuguese, Russian, Chinese, Japanese	
	System Log	Up to 100 (Internal) Up to 4,000 (SDXC/SDHC/SD memory when the recording format is set to JPEG) error logs	
	Supported OS ³	Microsoft® Windows® 8.1, Microsoft® Windows® 8, Microsoft® Windows® 7, Microsoft® Windows Vista®	
	Supported Browser	Windows® Internet Explorer® 11 (32 bit), Windows® Internet Explorer® 10 (32 bit), Windows® Internet Explorer® 9 (32 bit), Windows® Internet Explorer® 8 (32 bit), Windows® Internet Explorer® 7 (32 bit), Safari, Google Chrome, Mozilla Firefox	
	Network	Network IF	10Base-T / 100Base-TX, RJ45 connector
		Image Resolution	•1.3 mega pixel [16 : 9] (30/60 fps) 1,280 x 720 / 640 x 360 / 320 x 180 / 160 x 90 •1.3 mega pixel [4 : 3] (30 fps) 1,280 x 960 / 800 x 600 / 640 x 480 / 400 x 300 / 320 x 240 / 160 x 120 •2 mega pixel [16 : 9] (30 fps) * Used by super resolution technology 1,920 x 1,080 / 640 x 360 / 320 x 180 / 160 x 90
H.264 ⁴		Transmission Mode	Constant bitrate / Variable bit rate / Framerate priority / Best effort / Advanced VBR
		Frame Rate	1 / 3 / 5 / 7.5 / 10 / 12 / 15 / 20 / 30 / 60 fps
		Bit Rate/Cient	64 / 128 / 256 / 384 / 512 / 768 / 1,024 / 1,536 / 2,048 / 3,072 / 4,096 / 6,144 / 8,192 / 10,240 / 12,288 / 14,336 / 16,384 / 20,480 / 24,576 / 30,720 / 40,960 kbps
		Image Quality	Low / Normal / Fine
		Smart Coding mode	On / Off (Only when "Variable bit rate" is selected)
Refresh interval		0.2 / 0.25 / 0.33 / 0.5 / 1 / 2 / 3 / 4 / 5s	
Transmission Type		Unicast / Multicast	
JPEG		Image Quality	10 steps
		Refresh interval	0.1 fps - 30 fps (JPEG frame rate will be restricted when displaying both JPEG and H.264 images.)
Transmission Type		Pull / Push	
Audio Compression (WV-SFV311A only)		G.726 (ADPCM) 32 kbps / 16 kbps, G.711 64 kbps / AAC-LC	
Audio Mode (WV-SFV311A only)		Off / Mic (Line) input / Audio output / Interactive (Half duplex) / Interactive (Full duplex)	
Authentication for Audio (WV-SFV311A only)		Level 1 only / Level 2 higher / All users	
Total Bit Rate	64 / 128 / 256 / 384 / 512 / 768 / 1,024 / 2,048 / 4,096 / 8,192 kbps / Unlimited		
Supported Protocol	IPv6 :	TCP/IP, UDP/IP, HTTP, HTTPS, RTP, FTP, SMTP, DNS, NTP, SNMP, DHCPv6, MLD, ICMP, ARP	
	IPv4 :	TCP/IP, UDP/IP, HTTP, HTTPS, RTSP, RTP, RTP/RTCP, FTP, SMTP, DHCP, DNS, DDNS, NTP, SNMP, UPnP, IGMP, ICMP, ARP	
FTP Client	Alarm image transmission, FTP periodic transmission (When the FTP transmission is failed, backup on an optional SDXC/SDHC/SD memory card is available.)		
No. of Simultaneous Users	Up to 14 users (Depends on network conditions)		

Network	SDXC/SDHC/SD Memory Card (Option)	H.264 recording : Manual REC / Alarm REC (Pre/Post) / Schedule REC / Backup upon network failure JPEG recording : Manual REC / Alarm REC (Pre/Post) / Backup upon network failure Compatible SD (SDHC/SDXC) card : Panasonic 2 GB, 4 GB*, 8 GB*, 16 GB*, 32 GB*, 64 GB**, 128 GB***model *SDHC card, ** SDXC card (except miniSD card and microSD card)
	Cellular Phone Compatibility	JPEG image, AUX control (by access level)
Alarm	Mobile Terminal Compatibility	iPad, iPhone, iPod touch (iOS 4.2.1 or later), Android™ mobile terminals
	Alarm Source	3 terminals input, VMD, Command alarm, Audio detection alarm (WV-SFV311A only)
Input/Output	Alarm Actions	SDXC/SDHC/SD memory recording, E-mail notification, HTTP alarm notification Indication on browser, FTP image transfer, Panasonic protocol output
	Alarm Log	With SDXC/SDHC/SD memory card : Up to 50,000 logs for each SD memory card Schedule : Alarm / VMD / Access permission / H.264 recording / Scene file
General	Monitor Output (for adjustment)	VBS : 1.0 V [p-p] / 75 Ω, composite, ø3.5 mm monaural mini jack An NTSC or PAL signal can be outputted from camera (either press the INITIAL SET switch quickly (within 1 second) or use software to select NTSC or PAL signal).
	Microphone/Line Input (WV-SFV311A only)	ø3.5 mm monaural mini jack (monaural input) (Applicable microphone : Plug-in power type) Supply voltage : 2.5 V ± 0.5 V Input impedance : Approx. 2 kΩ (unbalanced)
	Audio Output (WV-SFV311A only)	ø3.5 mm stereo mini jack (monaural output) Output impedance: Approx. 600 Ω (unbalanced)
	External I/O Terminals	ALARM IN 1 (DAY/NIGHT IN*, Auto time adjustment), ALARM IN 2 (ALARMA OUT), ALARM IN 3 (AUX OUT) *WV-SFV311A only
	Safety	UL (UL60950-1), C-UL (CAN/CSA C22.2 No.60950-1), CE, IEC60950-1
	EMS	FCC (Part15 ClassA), ICES003 ClassA, EN55022 ClassB, EN55024
	Power Source and Power Consumption	DC power supply : DC12 V / 710 mA / Approx. 8.5 W PoE (IEEE802.3af) : DC48 V / 200 mA / Approx. 9.6 W (Class D device)
	Ambient Operating Temperature	-40 °C to +50 °C (-40 °F to 122 °F)
	Ambient Operating Humidity	10 to 90 % (no condensation)
	Impact Protection	IEC 60068-2-75 test Eh, 50 J / IEC 62262 IK10
	Water and Dust Resistance	IP66, IEC60529 measuring standard compatible, Type 4X(UL50), NEMA 4X compliant
	Shock Resistance	Compliant with 50 J IEC60068-2-75
	Dimensions	ø164 mm x 139 mm (H) (ø6-15/32 inches x 5-15/32 inches (H)) * Installing using the base bracket Dome radius 42 mm (1-21/32 inches)
	Mass (approx.)	When using base bracket : 1.6 kg (3.53 lbs) When using attachment plate : 1.2 kg (2.65 lbs)
	Finish	Main body : Aluminum die cast, light gray Dome cover : Clear polycarbonate resin

- *1 Converted value
*2 Super Dynamic function is automatically set off on 60 fps mode.
*3 Refer to "Notes on Windows Vista® / Windows® 7 / Windows® 8 / Windows® 8.1" on the provided CD-ROM for further information about system requirements for a PC and precautions when using Microsoft® Windows® 8.1 or Microsoft® Windows® 8 or Microsoft® Windows® 7 or Microsoft® Windows Vista®.
*4 Transmission for 4 streams can be individually set.

Part Names and Functions

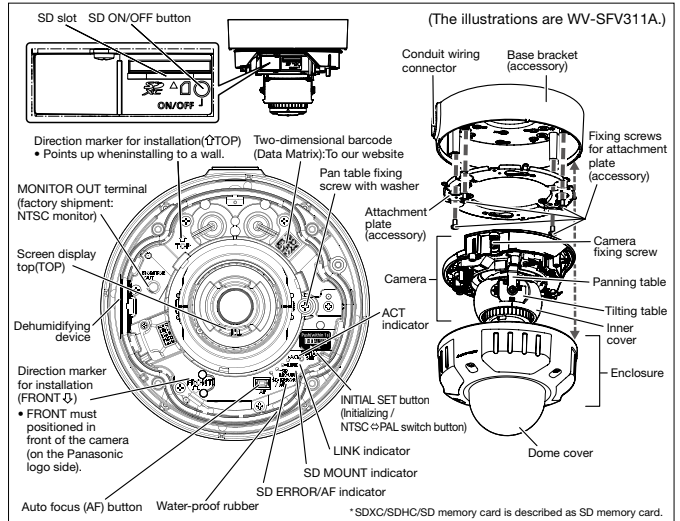

Appearance

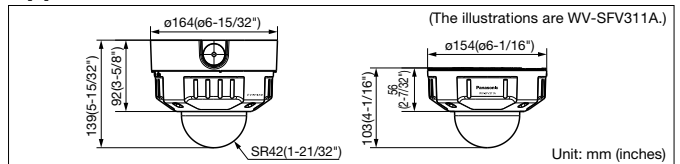

Trademarks and registered trademarks

- Microsoft, and Windows are registered trademarks of Microsoft Corporation in the U.S. and other countries.
- "i-PRO SmartHD" logo is trademark or registered trademark of Panasonic Corporation.
- ONVIF and the ONVIF logo are trademarks of ONVIF Inc.
- All other trademarks identified herein are the property of their respective owners.

Important

- Safety Precaution: Carefully read the Important Information, Installation Guide and operating instructions before using this product.
- Panasonic cannot be responsible for the performance of the network and/or other manufacturers' products used on the network.

- Masses and dimensions are approximate. • Specifications are subject to change without notice.

DISTRIBUTED BY :

Panasonic

<http://security.panasonic.com>

<http://www.facebook.com/PanasonicNetworkCamera>

(2A-151BL)